

## Green Star – Office Interiors v1.1

### Indoor Environment Quality IEQ-7 External Views

Points Available	Points Claimed	CIR Submitted
2	2	N

#### Credit Criteria

Up to two points are awarded where it is demonstrated that a percentage of work settings have a direct line of sight through vision glazing, either externally or to an adequately sized and naturally lit internal atrium, as follows:

- 1 point = 60% of work settings;
- 2 points = 90% of work settings.

The distance to the nearest vision glazing is to be no more than eight metres.

#### Documents Provided

✓	Calculations that show that the NLA that is within eight metres of vision glazing, as a fraction of the total number of work settings (Shown in discussion below)
✓	As-built drawings that show the floor layout, the location of internal walls and partitions and their heights and materials, sight lines and the area which meets the Credit Criteria. Sight lines must take into account the thickness of external wall

#### Discussion

- Below are calculations that show that the NLA that is within eight metres of vision glazing, as a fraction of the total NLA:

**Total no. of work settings = 89**

Number of work settings (within 8m of glazing) =

Workstations = 55

Meeting Rooms = 8

Board Room = 10

Informal meeting rooms = 5

Bay meeting areas = 10

**Total no. of work settings (within 8m of glazing) = 88**

Number of work settings (within 8m of glazing) as a fraction of the total number of work settings) =

Total no. of work settings (within 8m of glazing) = 88

Total no. of work settings = 88

% of compliant work settings as a fraction of total no. of work settings =

=  $\frac{88}{88} \times 100$

= 100%

Therefore, eligible for 2 points since >90% of work settings are compliant.





BlighVollerNieldArchitecture

Telephone +61 3 9639 9199  
Facsimile +61 3 9639 9188  
www.bvn.com.au

**INTELLECTUAL PROPERTY**  
© COPYRIGHT BLIGH VOLLER NIELD PTY LTD (BVN), UNLESS OTHERWISE  
ADVISED IN WRITING, ALL RIGHTS TO USE THIS DOCUMENT ARE SUBJECT  
TO PROTECT IN FULL, OF ALL RIGHTS RESERVED. THIS DOCUMENT MAY ONLY  
BE USED FOR THE EXPRESS PURPOSE AND PROJECT FOR WHICH IT HAS BEEN  
CREATED AND DELIVERED, AND CANNOT BE REPRODUCED, COPIED, OR  
DOCUMENT MAY NOT BE OTHERWISE USED, OR COPIED, ANY UNAUTHORIZED  
USE OF THIS DOCUMENT IN AT THE USER'S RISK AND WITHOUT  
LITIGATION BEING THE USER'S RISK AND WITHOUT  
AND AGAINST ALL LOSS SO ARISING.

ISSUE	DATE	FOR
01	03.10.07	INFORMATION
02	09.10.07	INFORMATION
03	11.10.07	INFORMATION
04	17.10.07	APPROVAL
05	22.10.07	APPROVAL
06	22.10.07	CURTAIN RAILS DELETED
A	08.11.07	FOR CONSTRUCTION

**CONSULTANT**  
DAVIS LANGDON  
tel 02 9956 8822 fax 02 9956 8848  
**CONSULTANT**  
LINCOLNE SCOTT  
tel 02 8907 0900 fax 02 9957 4127  
**CLIENT**

**GBCA**  
L15, 179 ELIZABETH STREET  
SYDNEY NSW 2000  
CLIENT PROJECT NO.

**PROJECT**

**GREEN BUILDING COUNCIL  
OF AUSTRALIA**  
BVN PROJECT NUMBER

**M0709010**  
TRUE NORTH PROJECT NORTH

**GRAPHIC SCALE**  
0 2000 5000  
**SCALE**

1:100 at A2 DO NOT SCALE  
**STATUS**

**FOR CONSTRUCTION**  
**DRAWING**

**GENERAL ARRANGEMENT  
FLOOR PLAN**

DRAWING NUMBER	ISSUE
A-D-01	A

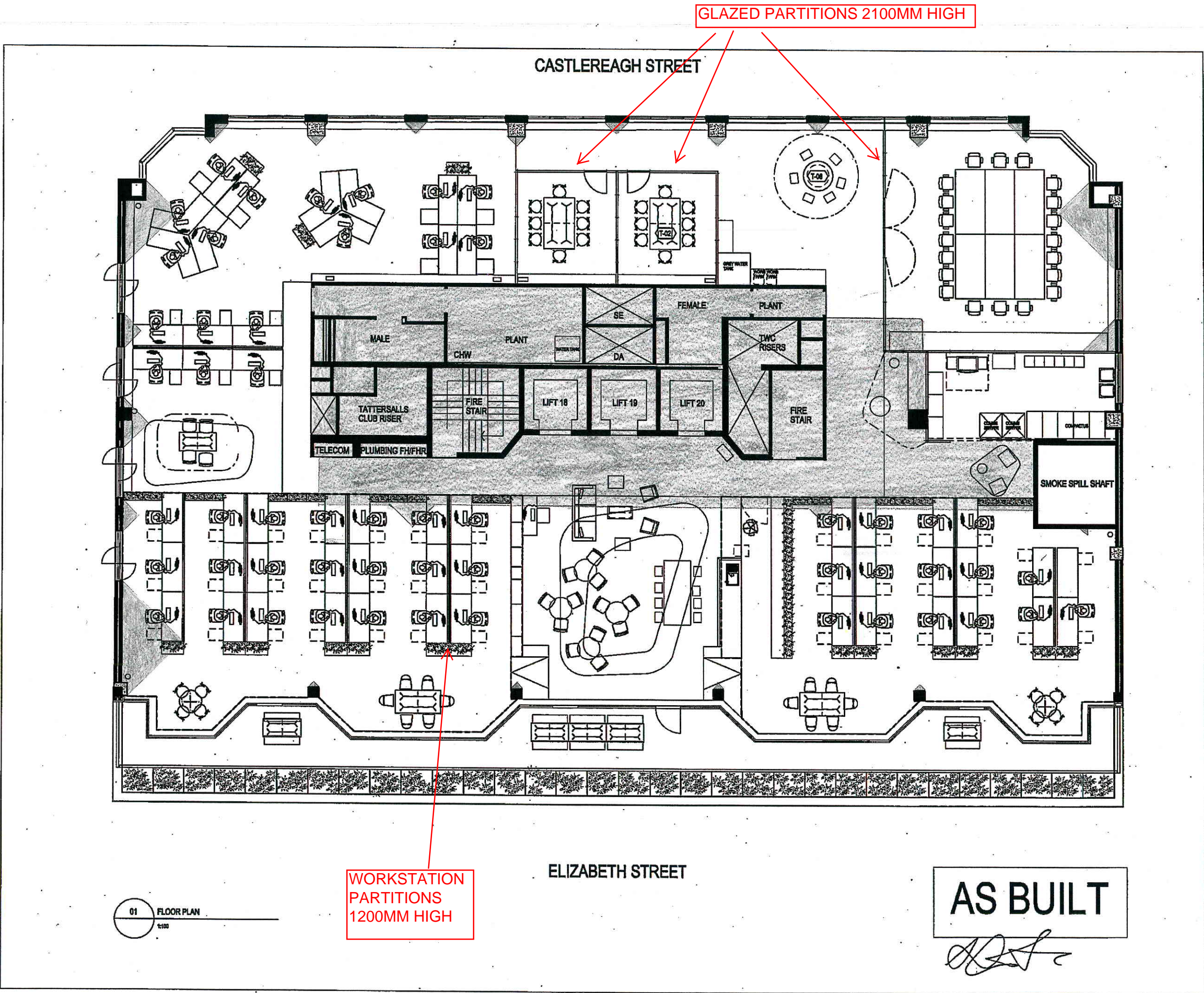

01 FLOOR PLAN  
1:100

WORKSTATION  
PARTITIONS  
1200MM HIGH

ELIZABETH STREET

AS BUILT